

E 479957.304
N 2768607.427

E 479988.478
N 2768614.649

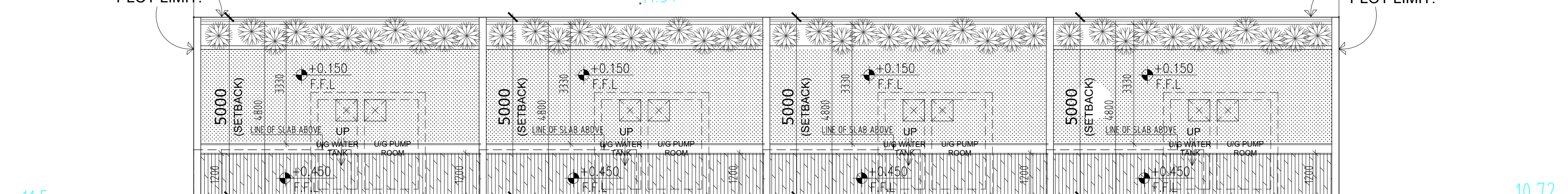

PROPOSED TOWNHOUSES (4NO.S)

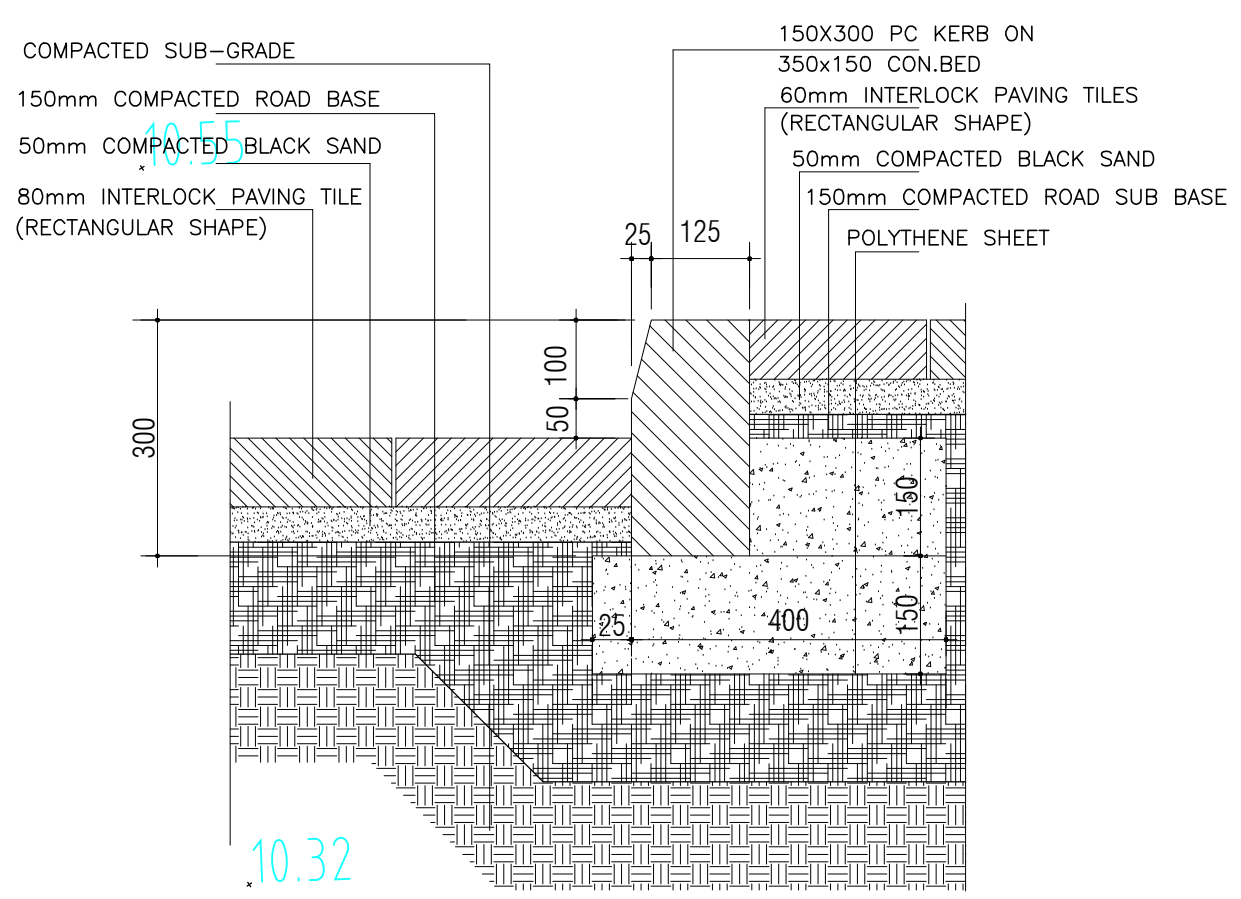
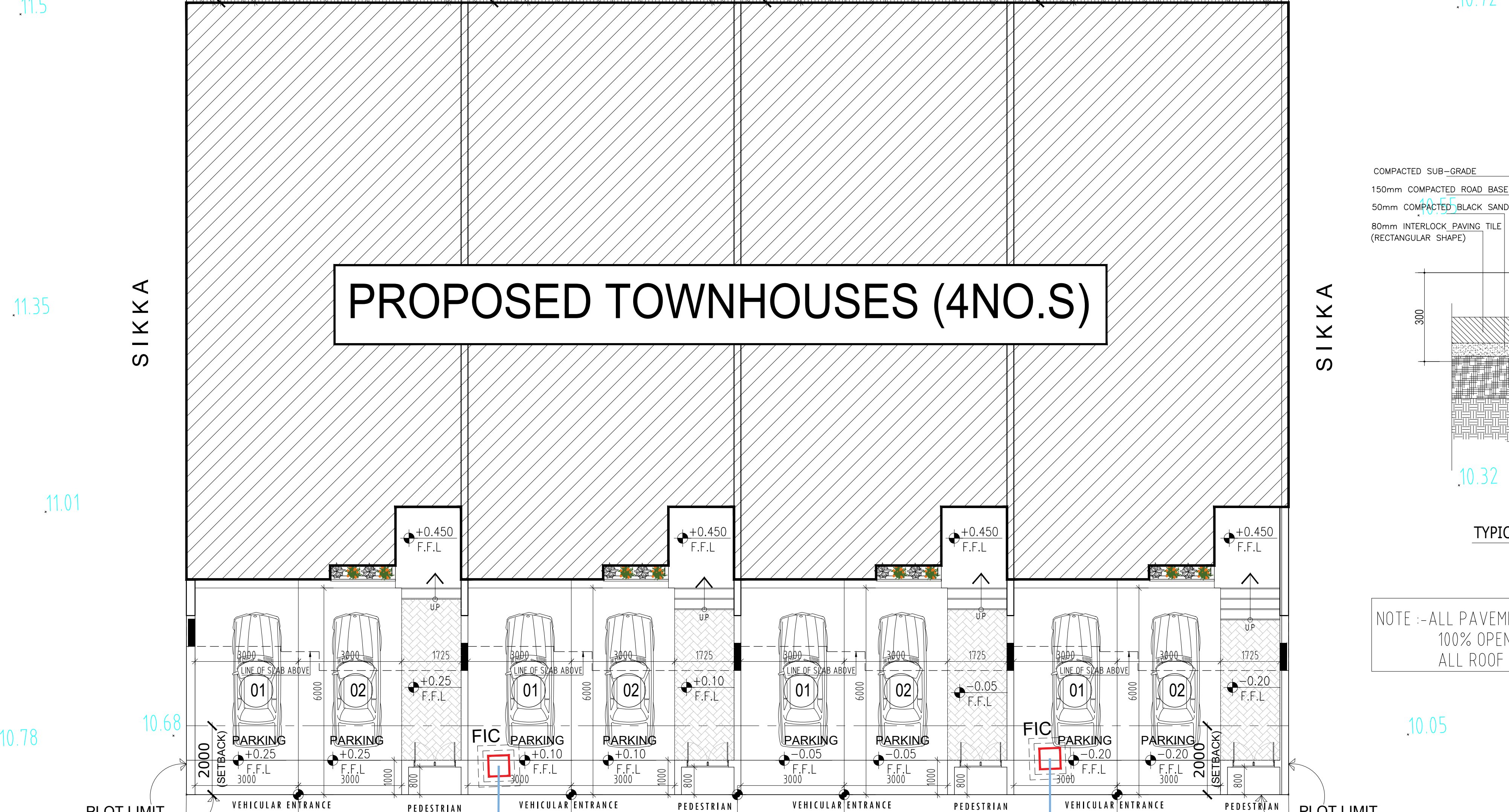

NOTE :- ALL PAVEMENT & INTER LOCKING TILES WITH SRI ≥ 29%
100% OPEN GRID PAVEMENT SYSTEM
ALL ROOF TILES SRI > 78%

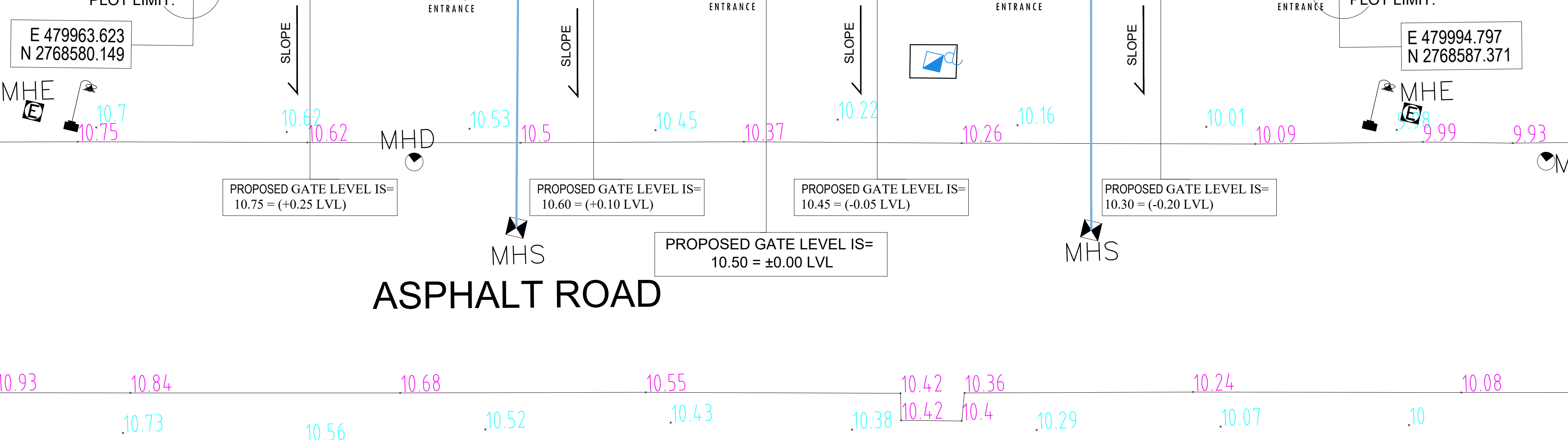

PLOT NO	AFWBTH023
ZONE	JABAL ALI FIRST 591
PHASE	<input type="checkbox"/> GA <input checked="" type="checkbox"/> CP <input type="checkbox"/> SP

NOTES:

- THIS DRAWING MAY NOT BE REPRODUCED BY ANY MEANS WITHOUT PRIOR APPROVAL FROM EMSQUARE
- DRAWINGS ARE NOT TO BE SCALED, STATED DIMENSIONS ONLY ARE TO BE TAKEN.
- ANY INCONSISTENCY OR DISCREPANCY IS TO BE BROUGHT TO THE ATTENTION OF & RESOLVED BY THE ARCHITECT/ENGINEER BEFORE THE WORK IS PUT IN HAND.

DATE	DESCRIPTION	BY

CONSULTANT :
EMSQUARE
ENGINEERING CONSULTANTS
Architects & Civil Engineers
TEL NO: +971 4 2729009 FAX NO: +971 4 2729334
P.O. Box: 181903 Dubai
e-mail: emsquare@emirates.net.ae

OWNER :
IQSAS INVESTMENT LIMITED

JOB TITLE :
PROPOSED TOWN HOUSES
(RESIDENTIAL)

PLOT NO. / PARCEL ID	BLOCK / COMMUNITY
AFWBTH023	JABAL ALI FIRST 591

DRAWING TITLE :
SETTING OUT PLAN

ARCHITECT :	STRUCTURAL ENGR. :	DRAWN :
ROCEL	SYED	BIJU
SCALE :	DATE :	CHECKED BY :
1:100	NOV-2020	BABU
JOB NO. :	DRAWING NO. :	REVISION NO. :
—	A - 100	—